

HILTI

100

X-ECT MX # 285709

Made in Slovenia



Info | Shop



qr.hilti.com/285709

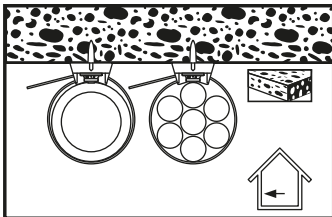

CE
16
Hilti AG
FL-9494 Schaan
Hilti-DX-DoP-005
ETA-16/0301
EAD 330083-02-0601
0672
0672-CPR-0624
Power-actuated fastener for multiple use in concrete for non-structural applications

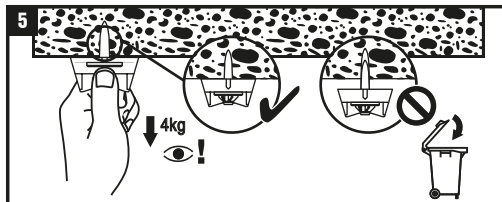
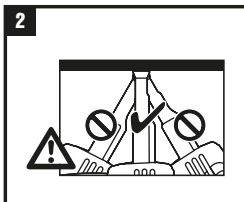
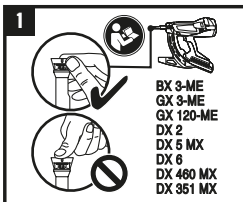
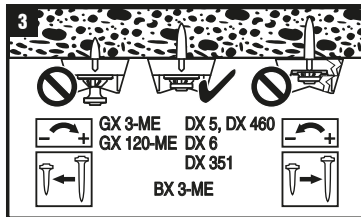

2079610-10.2021



Material Classification	Cat. No.	Type Desig.	Mounting Dimensions mm (in) Hole Dia.	Mechanical Strength N (lbs)	Operating Temp °C min. max.	Indoor/ Outdoor	Plenum Rating
Non-metallic/Altech	X-ECT	21	3.0 (0.118)	111 (25)	0 65	Indoor	AH-2